



FreeStyle Libre 2

FLASH GLUCOSE MONITORING SYSTEM

Quick Start Guide for FreeStyle Libre 2 Reader



Setup Overview

Refer to your User's Manual for full System instructions and information.

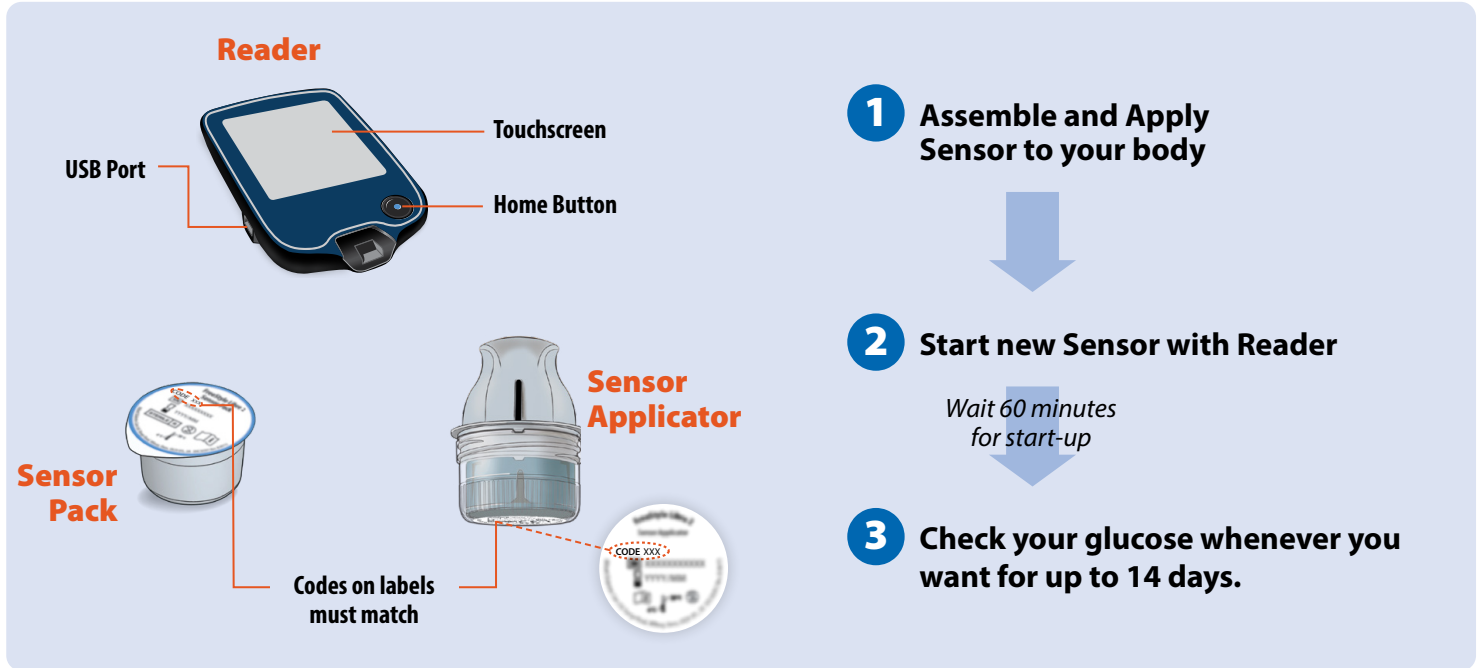

1 Assemble and Apply Sensor to the back of your upper arm

Get Ready

STEP 1

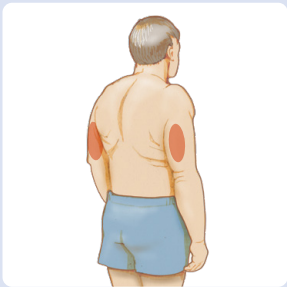

Select site on back of upper arm. Do not use other sites as these may result in inaccurate glucose readings.
Note: Avoid scars, moles, stretch marks, lumps, and insulin injection sites. To prevent skin irritation, rotate sites between applications.

STEP 2



Wash site using a plain soap, dry, and then clean with alcohol wipe. Allow site to air dry before proceeding.

STEP 3

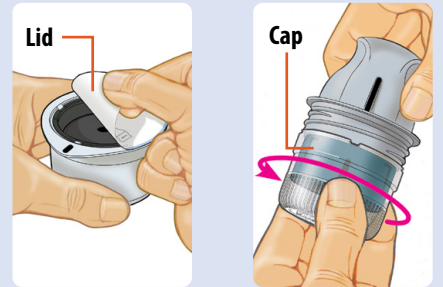

Peel lid completely off Sensor Pack. Unscrew cap from Sensor Applicator.

CAUTION: Sensor codes must match on Sensor Pack and Sensor Applicator or glucose readings will be incorrect.

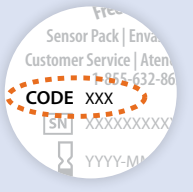

Prepare Sensor Applicator

STEP 4

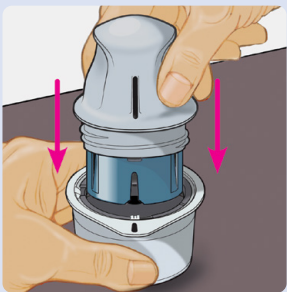

Line up dark mark on Sensor Applicator with dark mark on Sensor Pack. On a hard surface, press down firmly on Sensor Applicator until it comes to a stop.

STEP 5

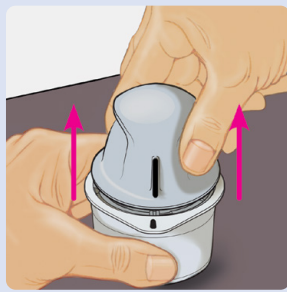

Lift Sensor Applicator out of Sensor Pack.

STEP 6



Sensor Applicator is ready to apply Sensor.

CAUTION: Sensor Applicator now contains a needle. Do not touch inside Sensor Applicator or put it back into Sensor Pack.

Apply Sensor

STEP 7

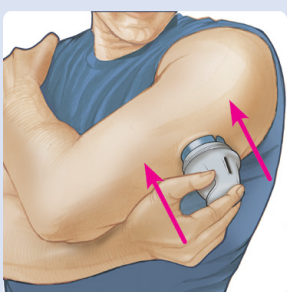

Place Sensor Applicator over site and push down firmly to apply Sensor.

CAUTION: Do not push down on Sensor Applicator until placed over prepared site to prevent unintended results or injury.

STEP 8

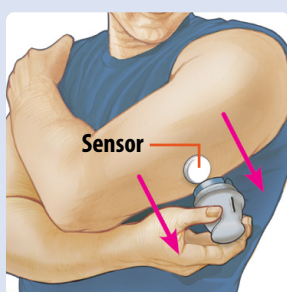

Gently pull Sensor Applicator away from your body.

STEP 9



Make sure Sensor is secure. Discard used Sensor Applicator and Sensor Pack according to local regulations.



2 Start new Sensor with Reader

STEP 1

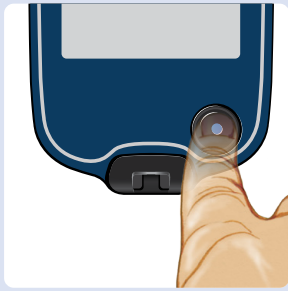

Press Home Button to turn on Reader.

Note: If using Reader for the first time, follow the prompts to set date and time.

STEP 2

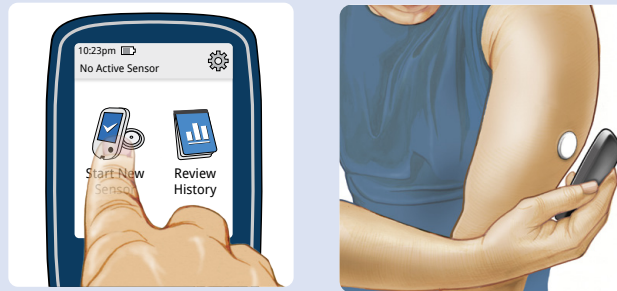

Touch **Start New Sensor**. Hold Reader within 1.5 inches (4 cm) of Sensor to scan it.

Note: Before you start your Sensor, choose which device you want to use. If you start the Sensor with the Reader, you will be unable to use the App to check your glucose or receive alarms.

STEP 3

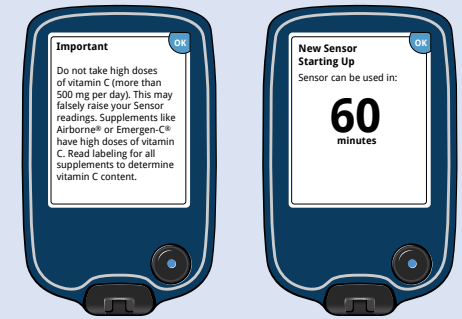

Review the important information on the screen.

Sensor can be used to check your glucose after 60 minutes.

3 Check your glucose

STEP 1



Press Home Button to turn on Reader.

STEP 2



Hold Reader within 1.5 inches (4 cm) of Sensor to scan it.

STEP 3

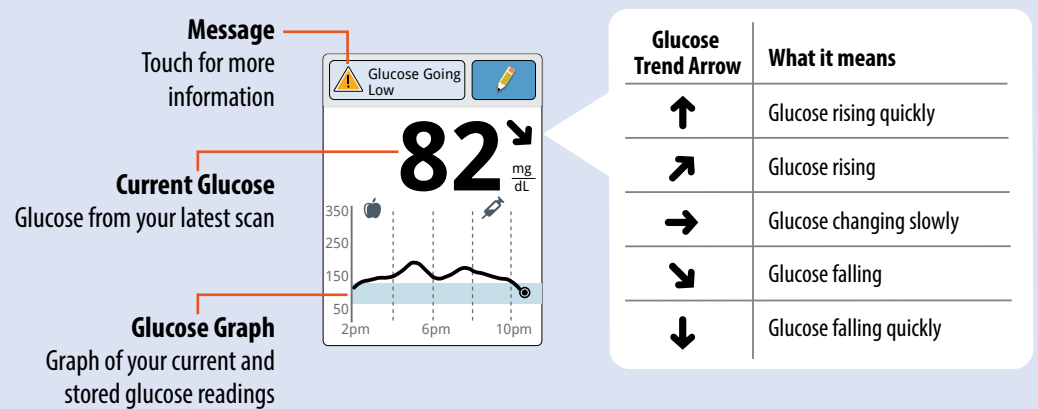

Reader shows your glucose reading. This includes your Current Glucose, Glucose Trend Arrow, and Glucose Graph.

Setting Alarms

The Sensor automatically communicates with the Reader and can give you glucose alarms. Alarms are on by default. To change their settings or turn alarms off, follow these steps.

IMPORTANT: Glucose alarms are an important safety feature. Please consult your health care professional before making changes.

STEP 1

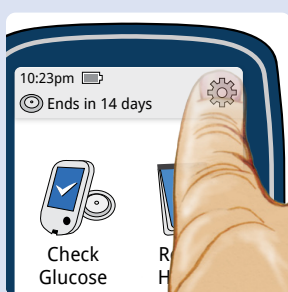

Press Home Button to go to Home Screen. Touch .

STEP 2

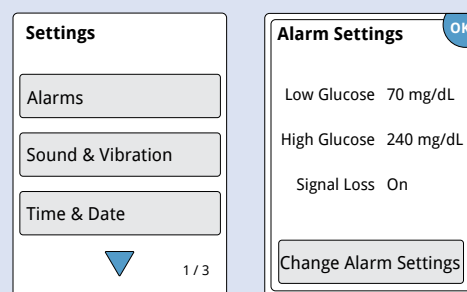

Touch **Alarms** and then touch **Change Alarm Settings**.

STEP 3

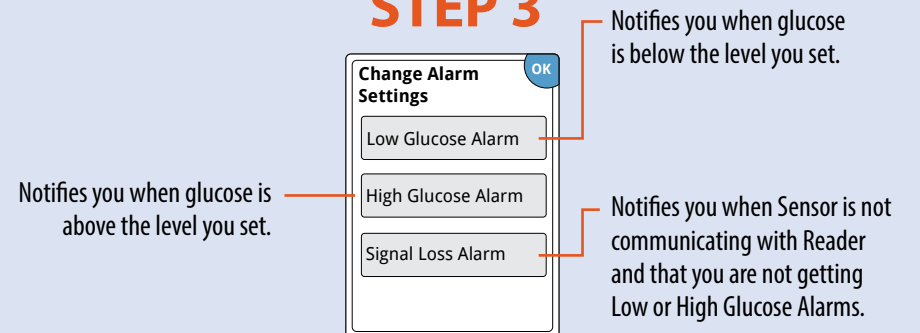

Select and set your alarms. Touch **done** to save.

Using Alarms

You must scan your Sensor to see your glucose reading.

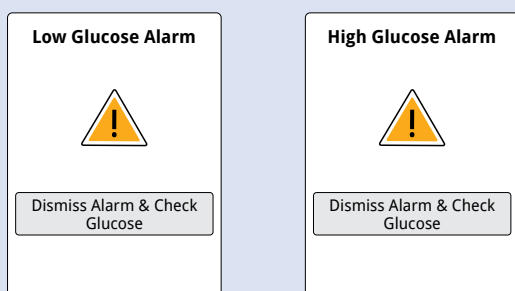

Touch **Dismiss Alarm & Check Glucose** or press the Home Button to dismiss alarm and check your glucose.

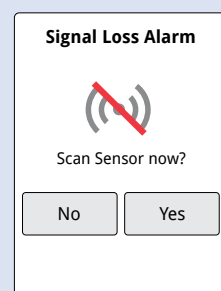

Touch **No** to dismiss alarm. Touch **Yes** or press the Home Button to dismiss alarm and scan the Sensor.

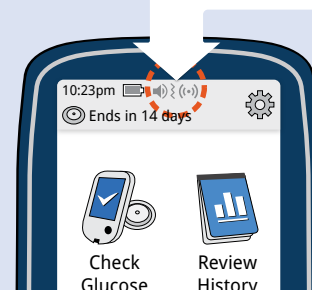

When any alarm is on, sound/vibration and signal status display on the Home Screen.

Symbol	What it means
	Sound and Vibration ON
	Sound and Vibration OFF
	Sensor communicating with Reader
	Sensor not communicating with Reader

Refer to User's Manual for additional symbols.

If you have followed the instructions described in the User's Manual and are still having difficulty setting up your System or if you are not sure about a message or reading, contact your health care professional.

The circular shape of the sensor housing, FreeStyle, Libre, and related brand marks are marks of Abbott. ©2018-2020 Abbott ART40392-003 Rev. A 01/21

Consult instructions for use

Manufacturer
Abbott Diabetes Care Inc.
1360 South Loop Road
Alameda, CA 94502 USA

